

## Contents

1. Introduction
2. Setup
3. Screen layout
4. Main functions
  - i. Vehicle management
  - ii. Book a service
  - iii. Customer care
  - iv. myHyundai
5. Configuration
6. Appendix
7. Trouble shooting

# Hyundai Auto Link



## User Guide.

### 1. Introduction.

#### About Hyundai Auto Link.

Hyundai Auto Link analyses your driving behaviour and monitors your vehicle for any fault codes. If any problems are detected with the vehicle, it automatically sends diagnostic data to the Hyundai Auto Link application (while the application is running). It also provides a convenient way to book your vehicle service with your Hyundai dealer.

#### Compatibility.

Only available on iOS and Android smart phones which support Bluetooth®4.0.

The DIAGNOSIS MODULE is designed to communicate with user's smart phone through BLE (Bluetooth Low Energy).

#### Downloading the Application.

Connect to the App Store or Google Play Store to download the Hyundai Auto Link application.

Components (already installed in your vehicle)



Diagnosis Module



OBD Adapter

#### Diagnosis Module.

The DIAGNOSIS MODULE is inserted into the vehicle OBD port with the OBD ADAPTER, and stores the driving history of the vehicle and transfers recorded data to your smart phone such as mileage, vehicle status and fault codes.

#### OBD Adapter.

The OBD ADAPTER is provided in order to fit the DIAGNOSIS MODULE into the fuse box.

# Hyundai Auto Link



## User Guide.

### Information Capture.

Hyundai Auto Link may collect the following information :

**Vehicle information:**

Vehicle Identification Number (VIN), License Plate Number, Odometer (ODO), Date of Purchase.

**Smart phone information:**

Number, WIFI Mac, Model, OS version, UUID, GPS (Personal Location Data if you have activated location services on your smart phone).

**DIAGNOSIS MODULE information:**

Bluetooth Mac, Serial number.

**Favorite Hyundai dealer and service centre**

**Driving information:**

Distance, Travel time, Average fuel efficiency rating, Fuel consumption.

**Driving history:**

Distance, Travel time, Average fuel efficiency rating, Fuel consumption.

**Statistics (ECO driving):**

Fuel efficiency rating, Fuel Consumption, Hard Braking, Rapid Acceleration.

**Statistics (Speed):**

Less than 40 km/h, ~80 km/h, ~120 km/h, ~160 km/h, over 160 km/h, Maximum RPM, Average RPM.

### Minimum Smartphone Requirement

Below is the minimum requirement to run the Hyundai Auto Link application for compatible devices,

1. **Android OS** - 4.3 version (After Galaxy S3 Model)
2. **iPhone** - iOS 8.1

### Application Setup

Search for “Hyundai Auto Link” in the App Store or Google Play Store and install.

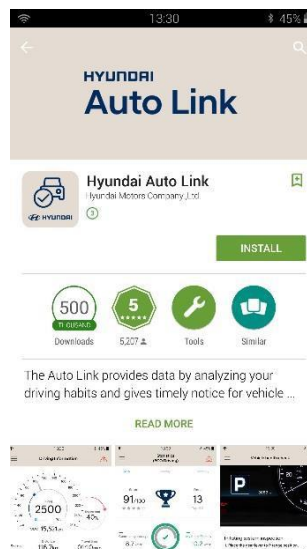
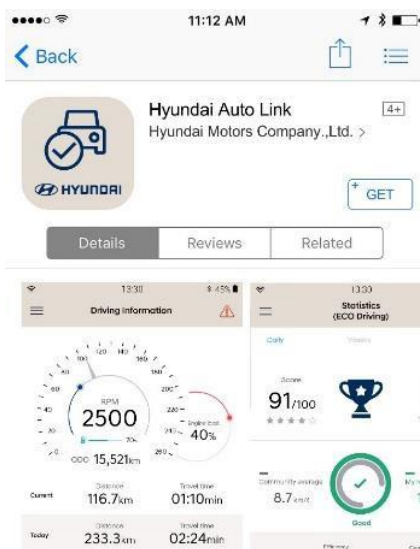

# Hyundai Auto Link



## User Guide.

### Note:

- Airplane mode must be turned off.
- Bluetooth and Location services must be turned on.

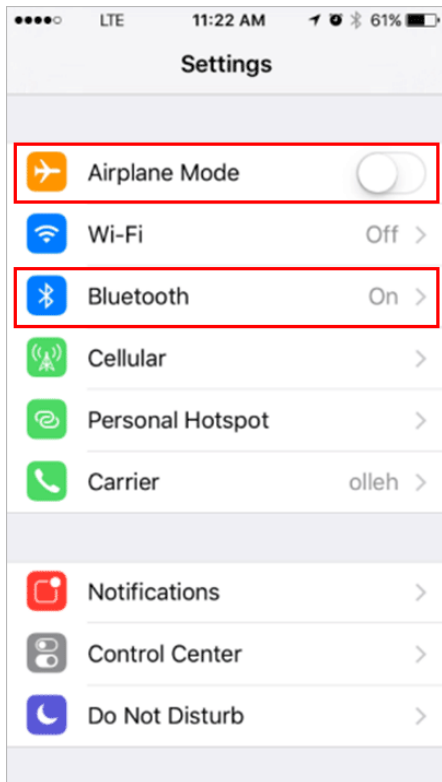

[iOS Settings]

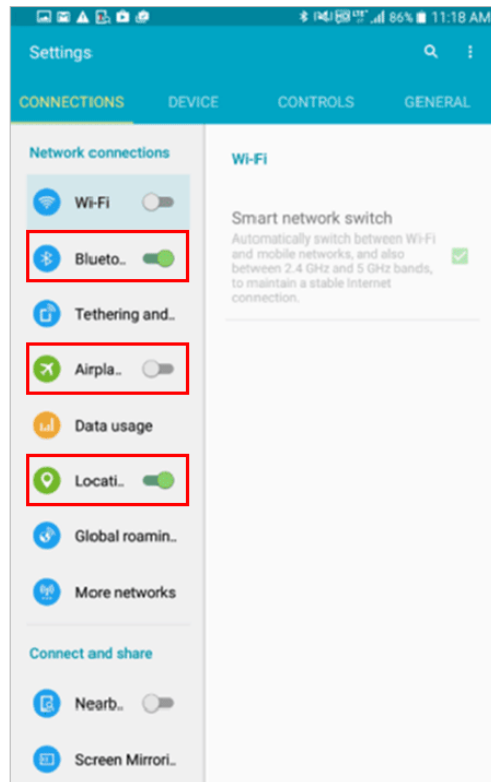

[Android Settings]

## User Guide.

### Terms and conditions

To use Hyundai Auto Link you must accept the terms and conditions and have read and understood Hyundai's Privacy Policy by pressing the “I accept” button.

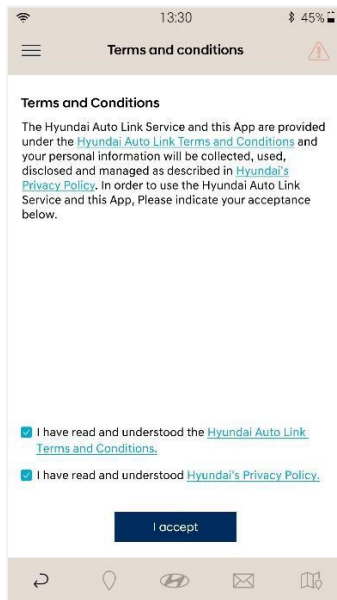

### Diagnosis Module – Connect (Step 1)

Press the “Start” button on the application to search for the diagnosis module in your vehicle.



## User Guide.

### DIAGNOSIS MODULE – Searching (Step 2)

Once the diagnosis module is detected and displayed, select it and press the 'Next' button.

The vehicle's identification number (VIN) is automatically detected by the DIAGNOSIS MODULE and captured. If the DIAGNOSIS MODULE is not able to obtain the VIN from the vehicle, retry the setup process.

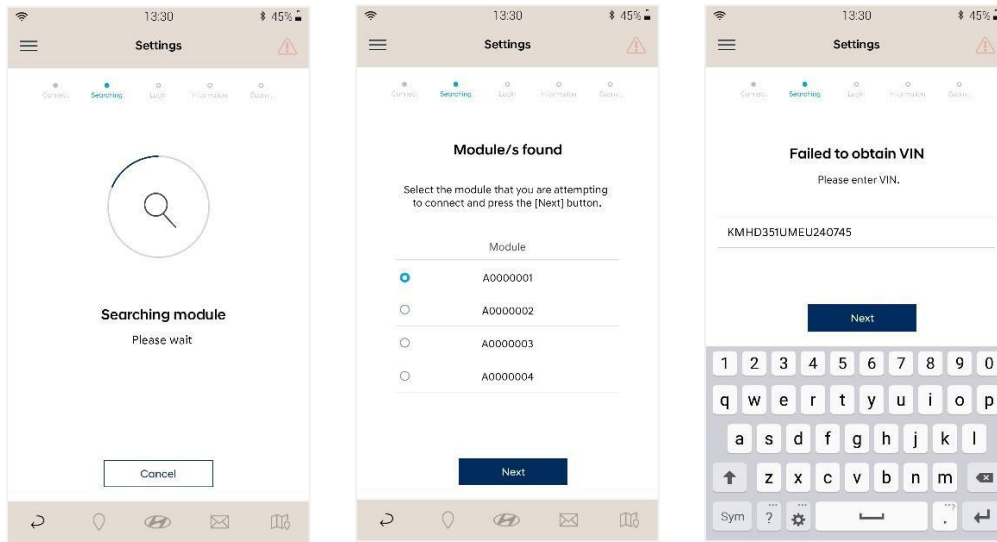

### DIAGNOSIS MODULE Settings – Login (Step 3)

Link Hyundai Auto Link to your myHyundai account.

1. To link to your myHyundai account, check the box and press the "Next" button.

*If you are the vehicle owner and would like to become a myHyundai owner, press the "Register" button and follow the instructions.*

2. If you don't want to link to myHyundai, leave the box unchecked and press the "Next" button. You will be prompted to enter your details.

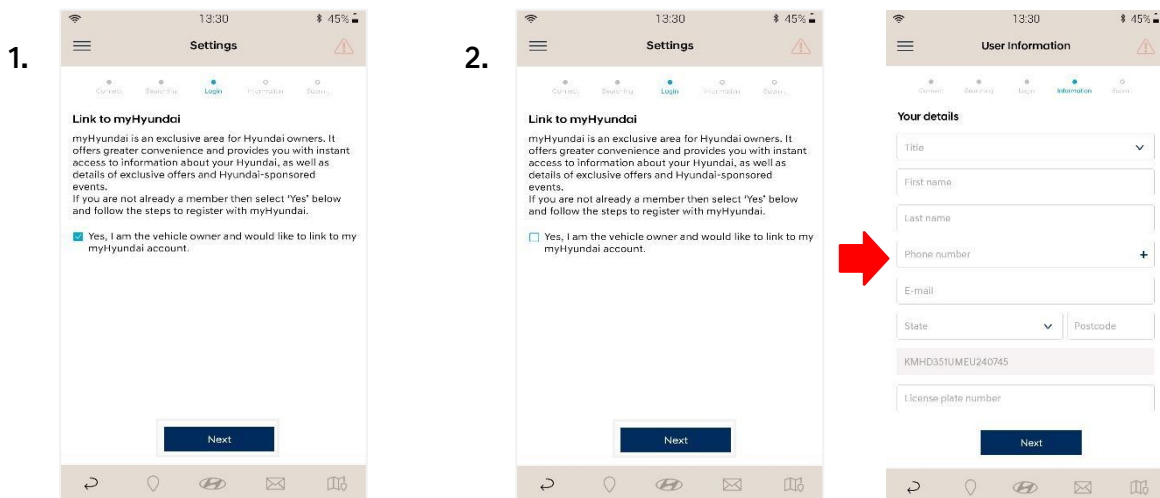

## User Guide.

If you would like to become a myHyundai member, press the “*Register*” button and follow the instructions. It is important you are the vehicle owner. After registering you must login to myHyundai to complete the setup process as per step '1.' shown above.

If you agree to link your myHyundai account, login using your myHyundai account details to use the Hyundai Auto Link application.

- Insert your ID/Username and Password to Login to myHyundai.
- Press ‘*Forgotten your password?*’ to retrieve your myHyundai password
- Press “*Register*” button if you need to register onto myHyundai.

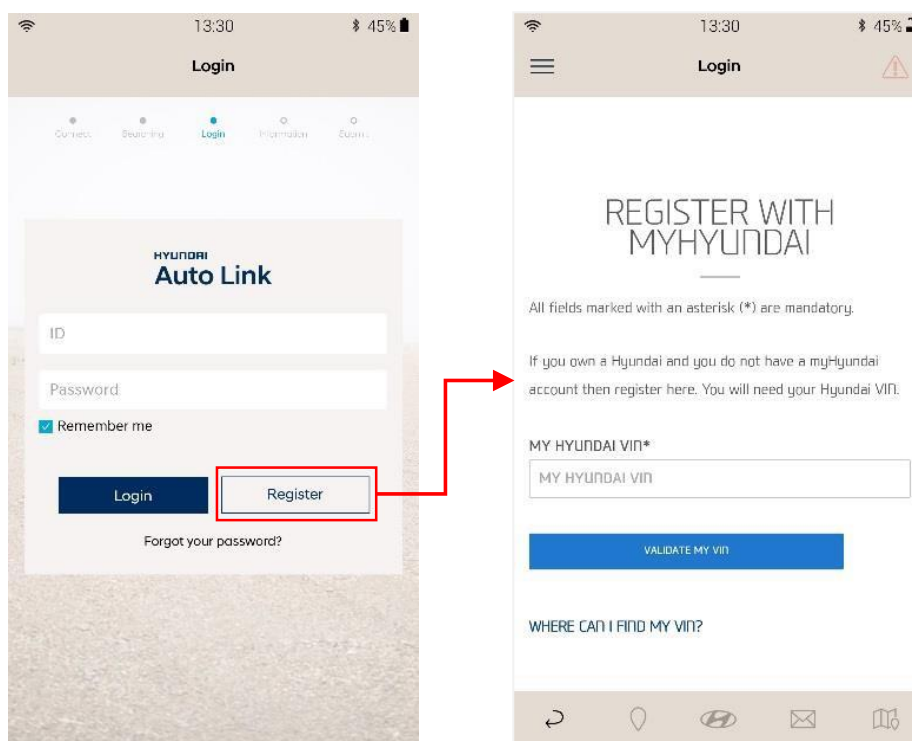

## User Guide.

### DIAGNOSIS MODULE Settings – User information (Step 4)

1. Link to myHyundai – Your user information will be automatically retrieved from your myHyundai account. You will need to complete the last few fields and press 'Next' to continue.

The screenshot shows the 'User information' screen in the Hyundai Auto Link app. The screen title is 'User information' and it has a warning icon. Below the title is a progress bar with five steps: 'Connect', 'Searching', 'Login', 'Information', and 'Submit'. The 'Information' step is currently active. The main instruction is 'Please enter the following information to complete the settings.' Underneath, there is a section titled 'Your details' with several input fields: a dropdown menu for 'Mr.', text boxes for 'John', 'Doe', and '123-123-4567', a text box for 'john@myhyundai.com', a dropdown for 'Sydney' and a text box for '2000', and a text box for 'KMHD351UMEU240745'. Below these are four more fields: 'License plate number', 'Odometer', 'Date of purchase' (with a calendar icon), and 'Favorite dealer' (with a location pin icon). A blue 'Next' button is at the bottom. A red box highlights the last four fields.

2. If you don't link to your myHyundai account, enter your information and press 'Next' to use the Hyundai Auto Link application.

The screenshot shows the 'User information' screen in the Hyundai Auto Link app, similar to the first one. The progress bar is the same. The 'Your details' section has a different set of fields: a dropdown for 'Title', text boxes for 'First name', 'Last name', and 'Phone number' (with a plus sign), a text box for 'E-mail', a dropdown for 'State' and a text box for 'Postcode', a text box for 'KMHD351UMEU240745', and text boxes for 'License plate number', 'Odometer', 'Date of purchase' (with a calendar icon), and 'Favorite dealer' (with a location pin icon). A blue 'Next' button is at the bottom. A red box highlights the fields from 'Title' down to 'Favorite dealer'.



## User Guide.

### DIAGNOSIS MODULE Settings – Submit (Step 5)

To complete the setup process, review your details and press the “Submit” button.

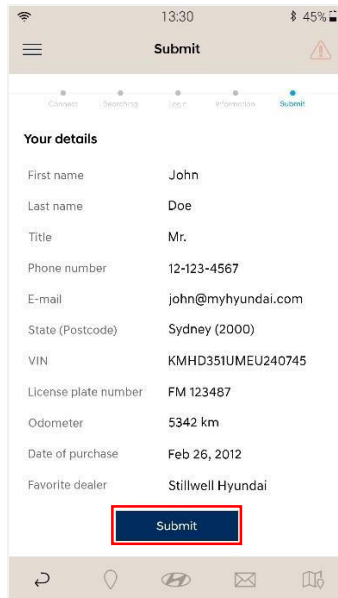

13:30 45%

Submit

Cancel Search Log Information Submit

**Your details**

First name	John
Last name	Doe
Title	Mr.
Phone number	12-123-4567
E-mail	john@myhyundai.com
State (Postcode)	Sydney (2000)
VIN	KMHD351UMEU240745
License plate number	FM 123487
Odometer	5342 km
Date of purchase	Feb 26, 2012
Favorite dealer	Stillwell Hyundai

Submit

## User Guide.

### 3. Screen layout.

This describes the basic functions available on the Hyundai Auto Link application.

- The default screen is the driving information screen.

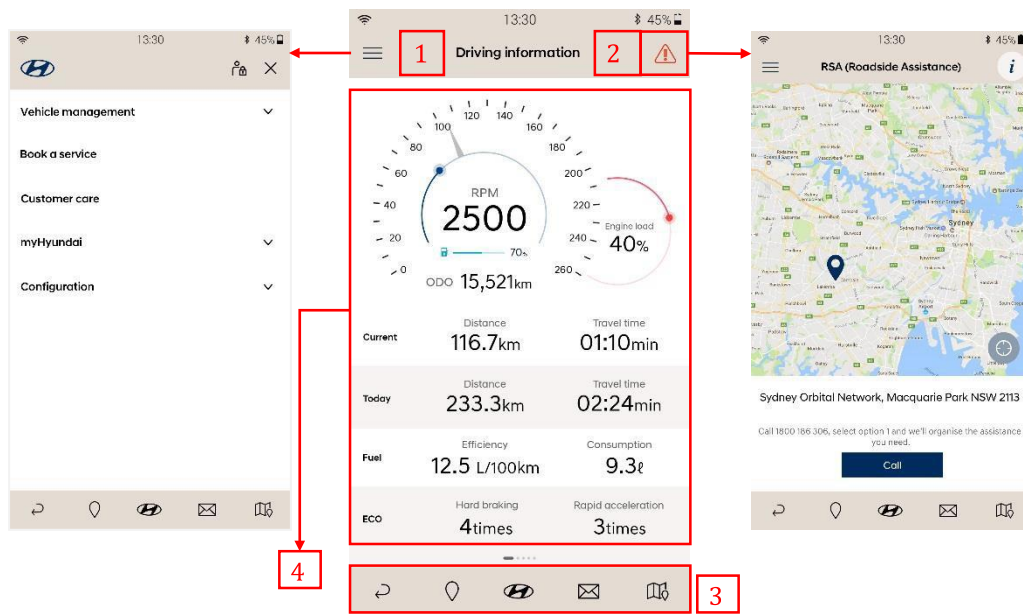

1. Menu: Allows navigation to other functions.
2. Roadside assistance (RSA): Allows the user to call the RSA call centre.
3. Hot keys (Bottom):
  - Back – return to previous screen
  - Dealer network
  - myHyundai Home
  - Message box
  - Map
4. Main functions:

Displays each function of the Hyundai Auto Link application.

# Hyundai Auto Link



## User Guide.

### Menu

- Vehicle management
- Book a service
- Customer care
- myHyundai
- Configuration

*Also, you can check the login status on the Menu.*

#### 1. Login screen

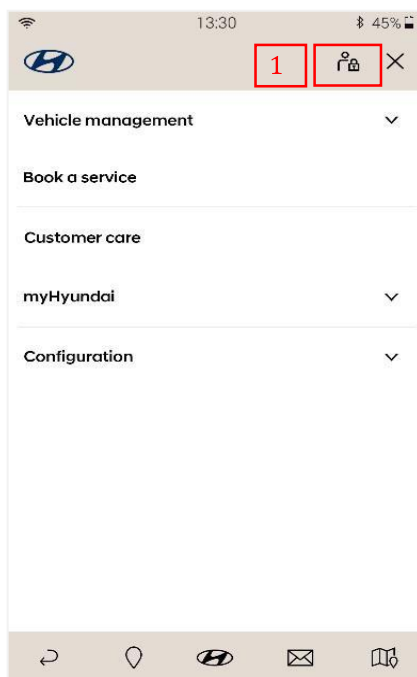

#### 2. Logout screen

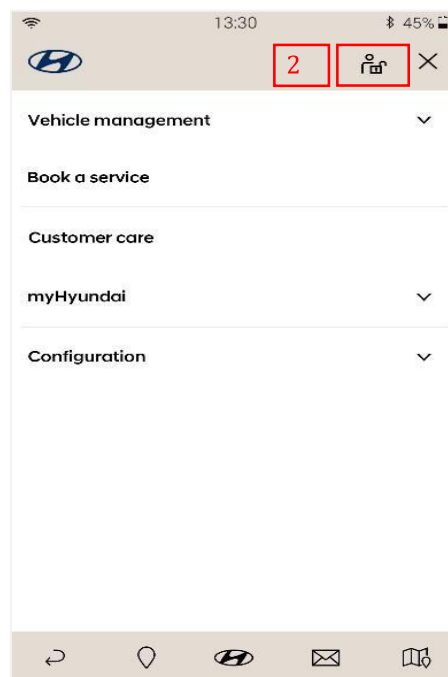

# Hyundai Auto Link



## User Guide.

### RSA (Roadside assistance)

Call RSA directly if a problem with your vehicle occurs.

1. Call to RSA centre
2. Information about RSA

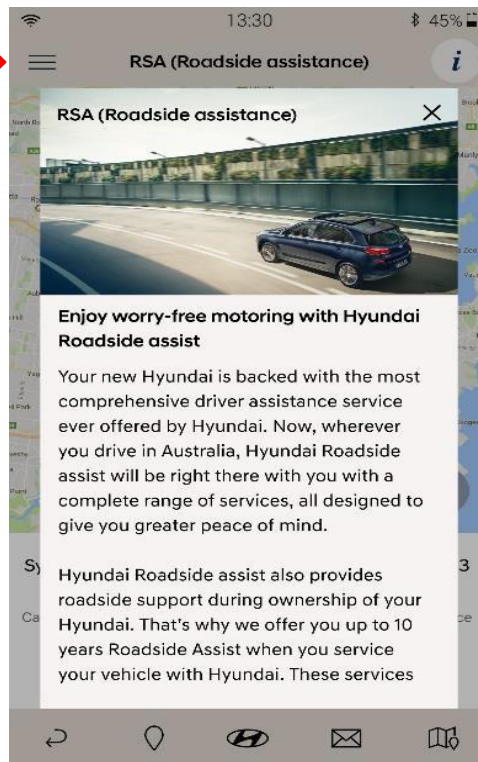
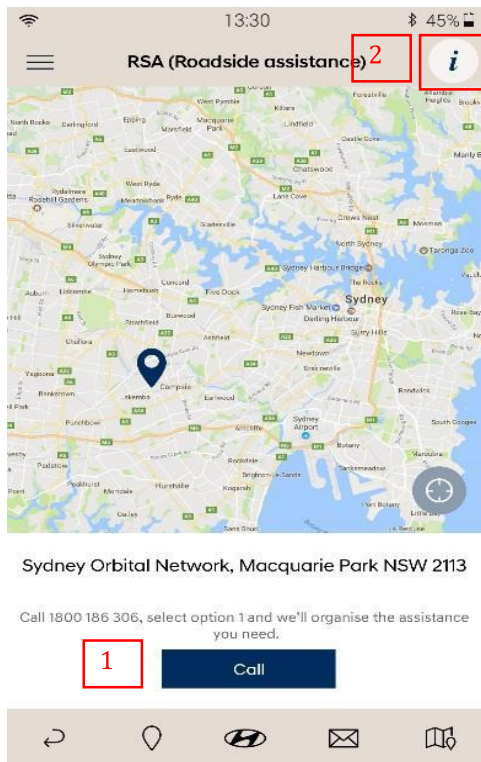

# Hyundai Auto Link



## User Guide.

### Hot Key (Bottom)

Allows easy navigation –

Back button, Dealer network, myHyundai home, Message box and Map.

#### 1. Back button

Allows the user to navigate back to the previous screen.



#### 2. Hyundai Dealer network

Shows Hyundai dealer information on the map.

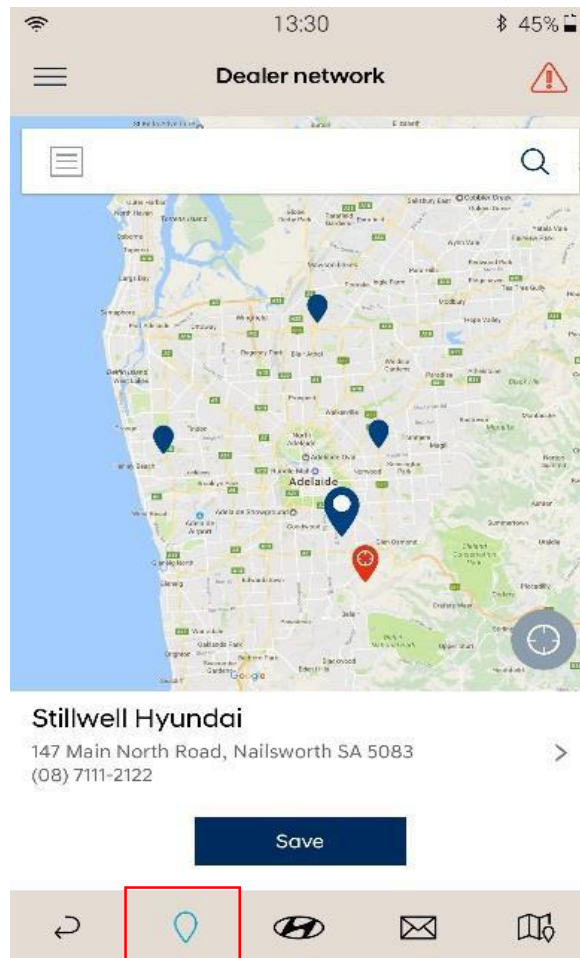

# Hyundai Auto Link



## User Guide.

### 3. myHyundai

Opens myHyundai (Note: user must be logged into myHyundai)

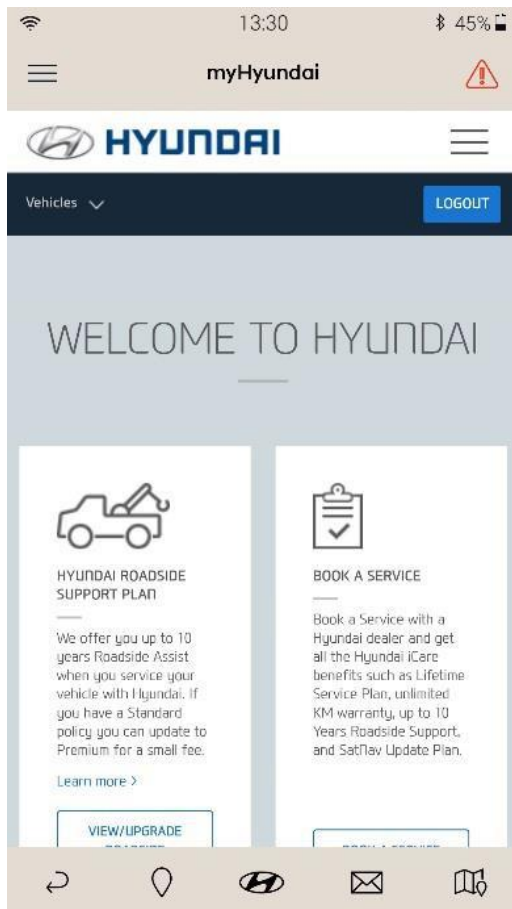

## User Guide.

### 4. Message box

\*Shows messages and notification sent from Hyundai.

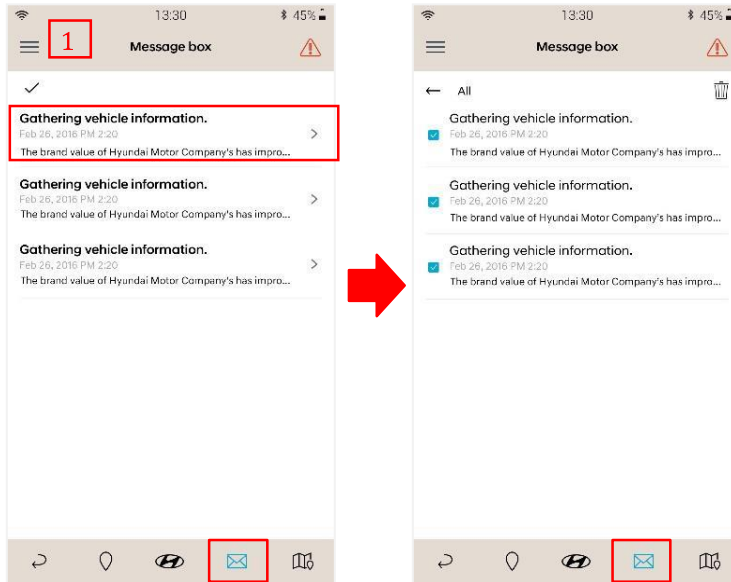

Messages can be deleted as follows:

1. Press  button on the upper left corner to activate the Message check boxes
2. Check the box next to the message you want to delete.
3. Press the “delete” button on the upper right corner to delete selected message/s.

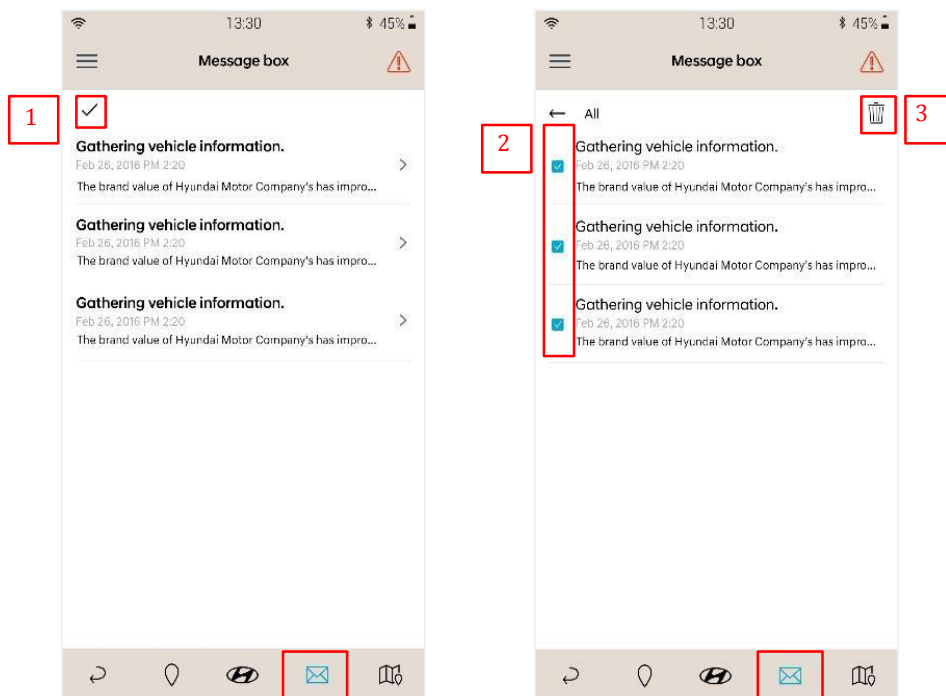

# Hyundai Auto Link



## User Guide.

### 5. Map

Shows your current location on the map (where you have activated location services on your smart phone).

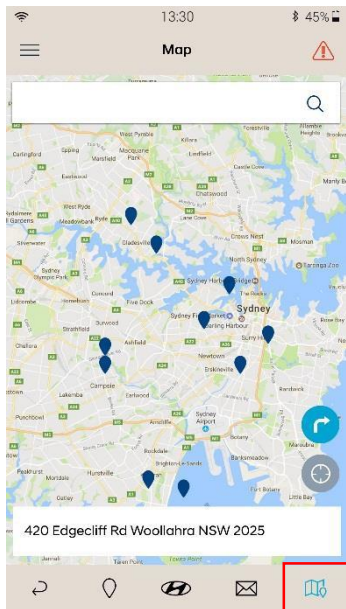

### 6. Main screen

Consists of three screens containing information about your vehicle. Swipe left or right to switch screens.

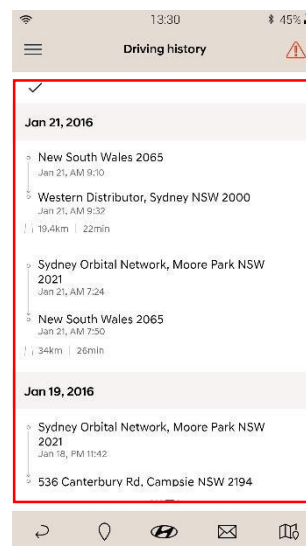
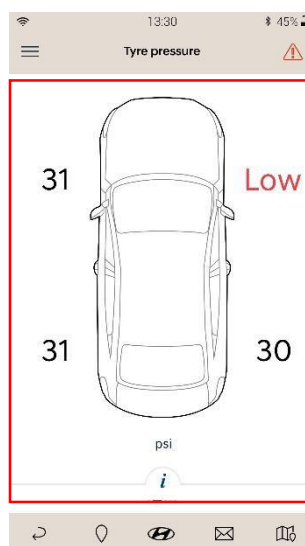
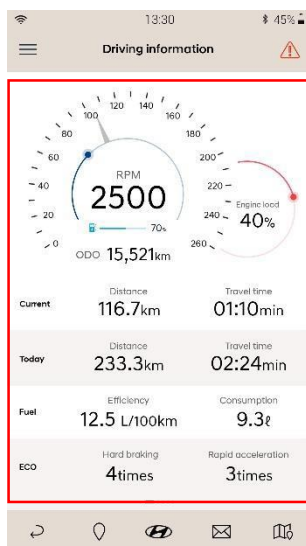



## User Guide.

### 4. Main Function

#### i. Vehicle management

Shows Driving information, Tyre pressure, Driving history, Vehicle health check and Parking management screens

- Swipe the screen left or right to switch screens.

#### Driving Information (default screen)

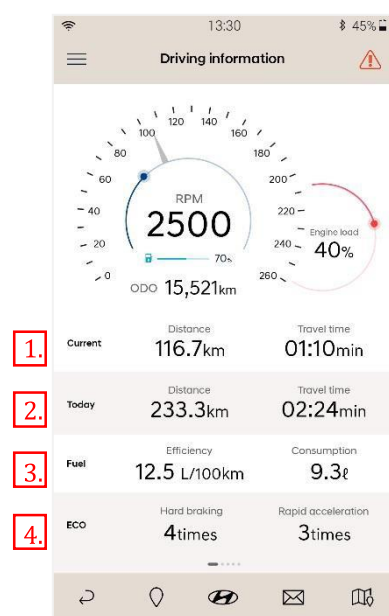

#### 1. Current

- Distance: The distance travelled for your current driving trip.
- Travel time: The time elapsed for your current driving trip.

#### 2. Today

- Distance: The total distance travelled for the day's driving trips.
- Travel time: The total time elapsed for the day's driving trips.

#### 3. Fuel

- Efficiency rating: measured from engine start to engine off
- Consumption: measured from engine start to engine off

#### 4. ECO

- Hard braking: The number of times hard braking occurred during current driving trip
- Rapid acceleration: The number of times rapid acceleration occurred during current driving trip

## User Guide.

### Tyre pressure

Shows the pressure for each of the vehicle tyres. If the tyre pressure is below the standard pressure then the tyre pressure will be displayed as Low in red.

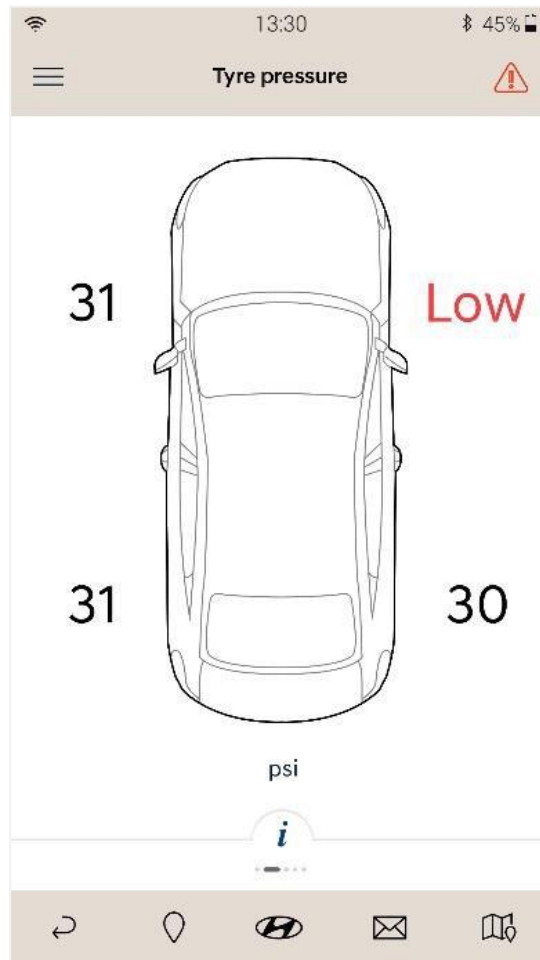

## User Guide.

### Driving history

The driving history is sorted by date. Each item consists of:

- Departure
- Arrival
- Maximum speed
- Average speed
- Average fuel efficiency rating
- Fuel consumption
- Rapid acceleration
- Hard braking
- Distance and travel time

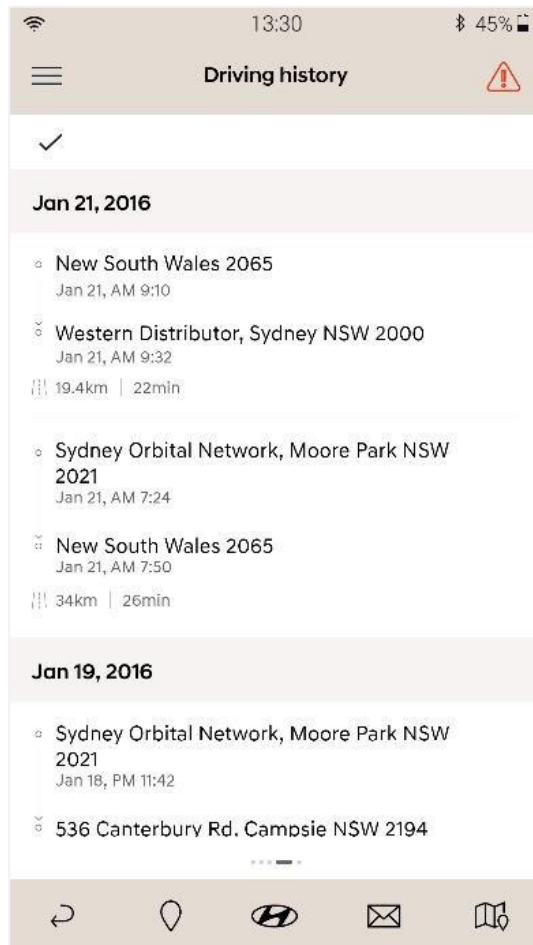

## User Guide.

### Check driving history

Shows driving history in the latest date order.

1. Select the item for more information.
2. For detail information, press the "i" button at the bottom.

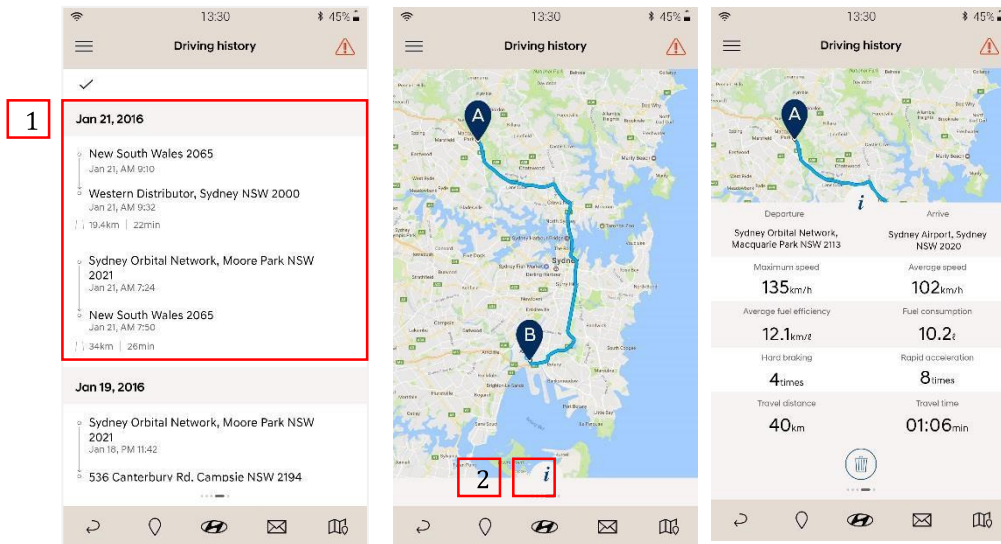

### Delete driving history

1. Press ✓ button on the upper left corner to activate the check box.
2. Select the box next to the item you want to delete.
3. Press the "Delete" button on the upper right corner to delete.

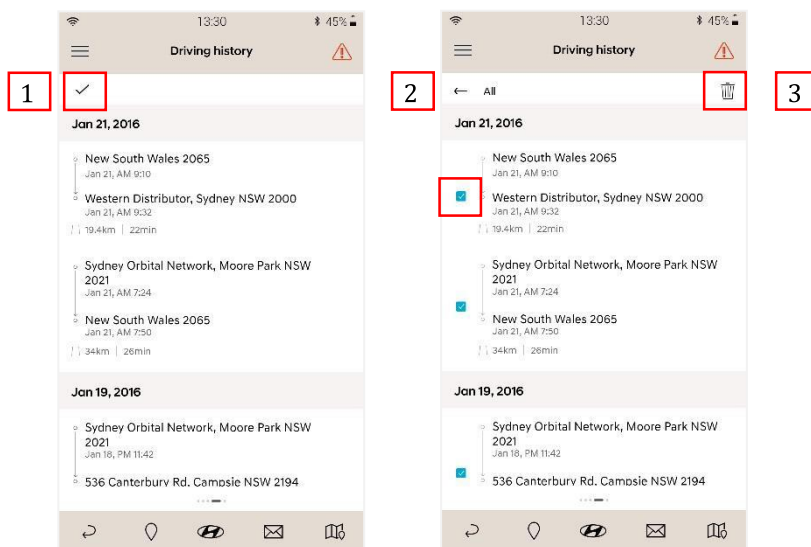

## User Guide.

### Vehicle health check

Diagnose the health of your vehicle. If a fault code is detected, it is captured automatically for diagnosis by Hyundai.

1. Initiating system inspection
  - Place the gear lever to “P” range position
  - Turn the Ignition to ON position
  - When you are ready, press “Start” button.

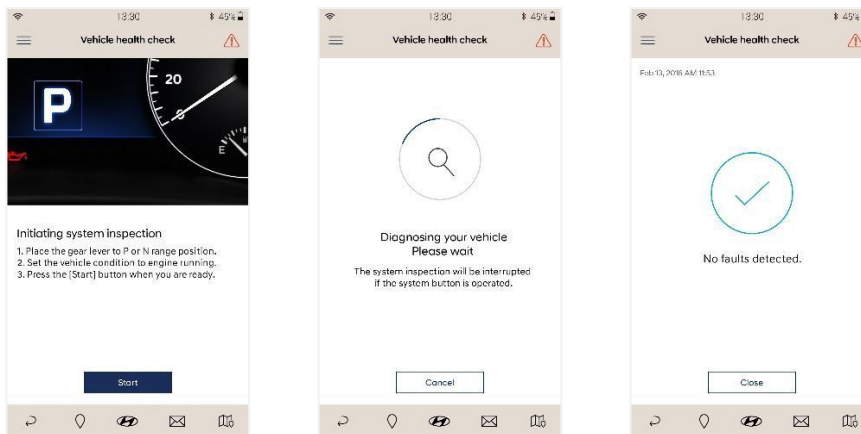

### Fault code detected

The alert notification will appear when a fault code is detected. Press the “call” button to call your favourite dealer and make a reservation for vehicle maintenance.

- When a fault code is detected, the diagnosis data will be sent to Hyundai for vehicle maintenance.

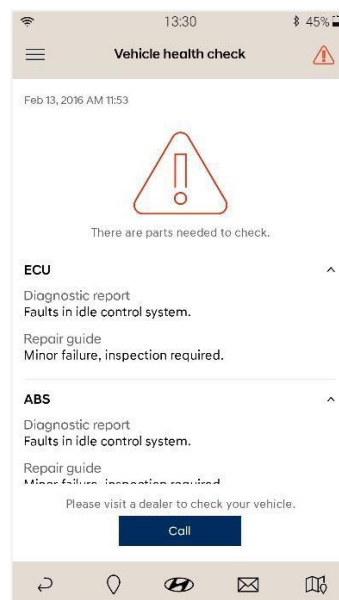

## User Guide.

### Parking management

Assists you to find your vehicle by saving your vehicle's parking location using the location services on the smart phone. You can also upload pictures of the parking location, enter notes and set a reminder for when the parking time expires.

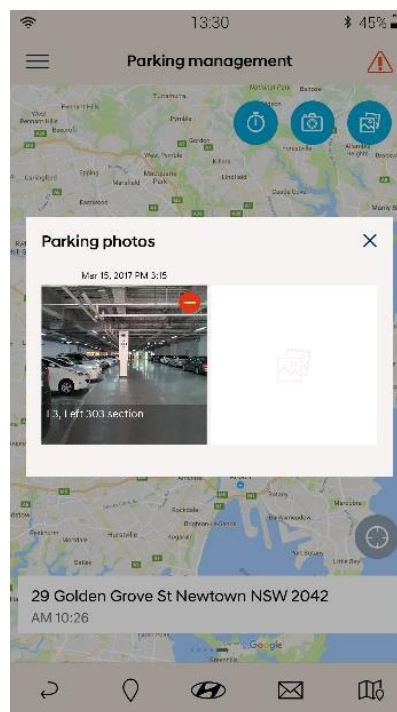
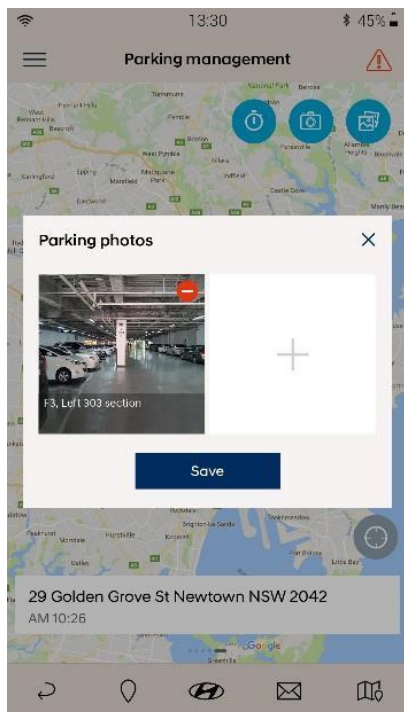
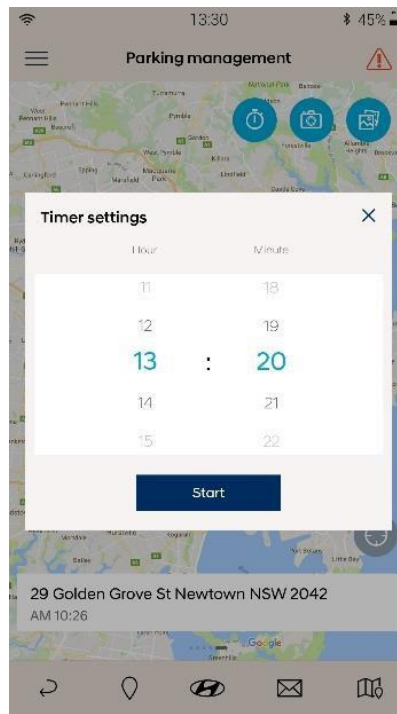

## User Guide.

### 4. Main Function

#### ii. Book a service.

A convenient way to book your vehicle's service.

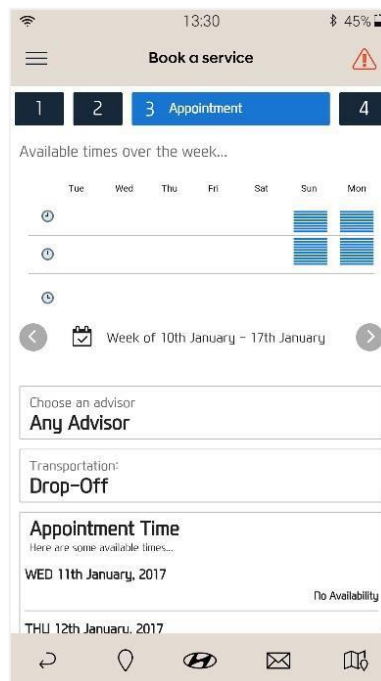
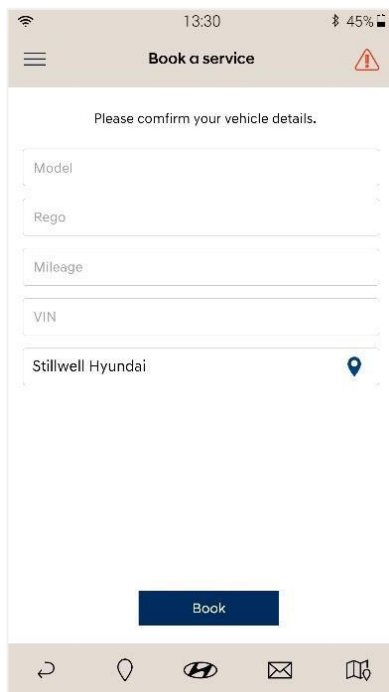

#### iii. Customer care.

Provides easy access to the Customers Care Centre, browse FAQs, complete an online request or call customer care directly.

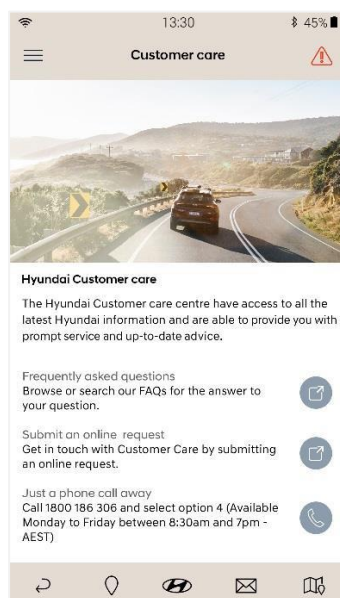

## User Guide.

### 4. Main Function iv. myHyundai.

Open the myHyundai portal.

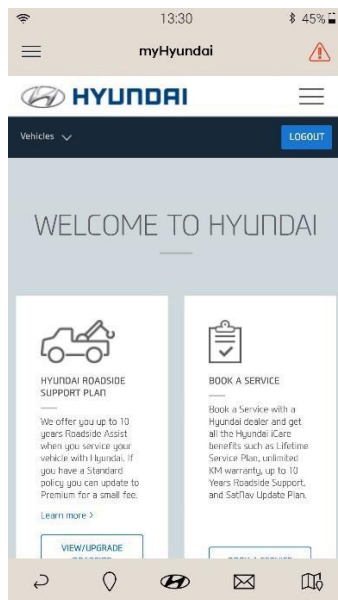

### Vehicle health report

Provides reports about the health of your vehicle.

1. Select the report item you want to view.
2. Press 'i' button to check the full name of diagnosis items.

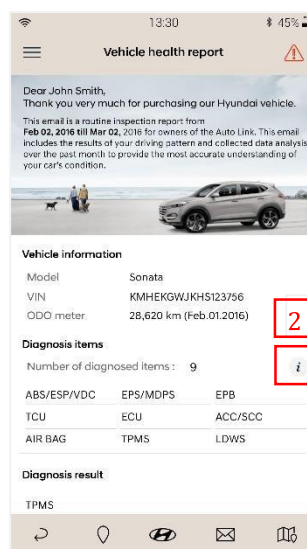
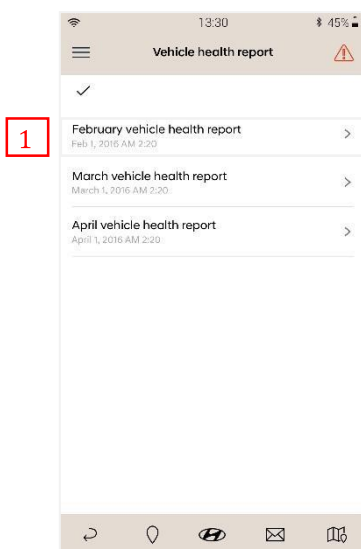



## User Guide.

### Statistics

Provides statistics of the user's driving pattern that can be viewed daily, weekly or monthly. Swipe the screen left or right to show Statistics (ECO Driving) or Statistics (Speed).

#### Statistics (ECO Driving)

Provides statistics of the user's driving pattern, results can be viewed daily, weekly or monthly.

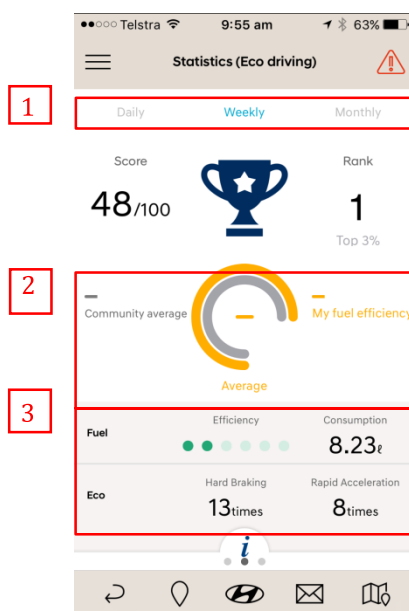

1. Statistics grouped: Daily, Weekly or Monthly.
2. ECO Driving Information
  - Community average
  - My fuel efficiency
3. Driving Pattern Analysis: Provides statistics for
  - Efficiency rating
  - Fuel consumption
  - Hard braking
  - Rapid acceleration

## User Guide.

### Statistics (Speed)

Provides statistics of the user's driving pattern, results are grouped daily, weekly or monthly.



1. Statistics grouped: Daily, Weekly or Monthly.
2. Driving Pattern Analysis:
  - Less than 40 km/h, ~80 km/h, ~120 km/h, ~160 km/h, over 160 km/h
3. Driving Pattern Analysis:
  - Maximum Speed, Average Speed, Maximum RPM and Average RPM.

## User Guide.

### 5. Configuration

The user can check the Hyundai Auto Link information such as Module setup, User Information, Application settings, Program version, Unit Settings, User guide, and Module diagnoses.

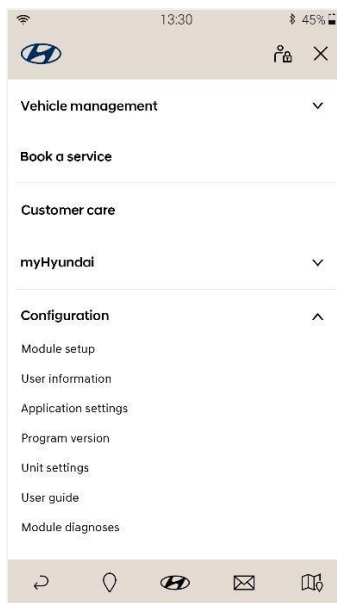

## User Guide.

### Module setup

Turn on your vehicle and press the 'Start' button to begin the module search. Select the detected DIAGNOSIS MODULE and press 'Next' to start the vehicle information retrieval step.

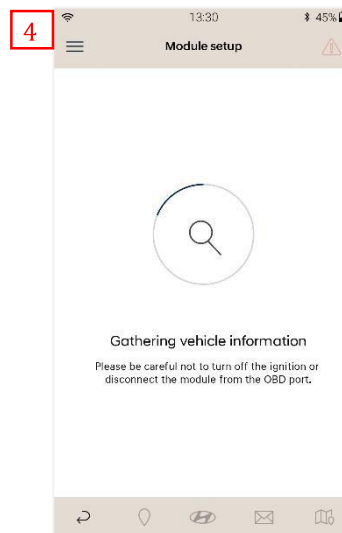
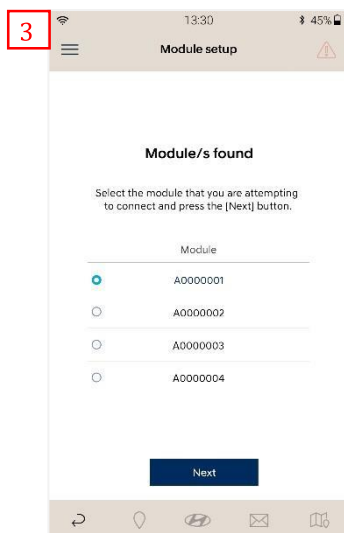
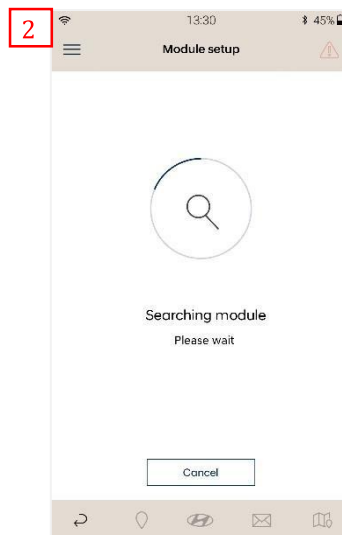

## User Guide.

### User information

Shows your user information.

1. Only partial user information can be modified when linked to myHyundai.
2. All user information except VIN can be modified if not linked to myHyundai.

**1**

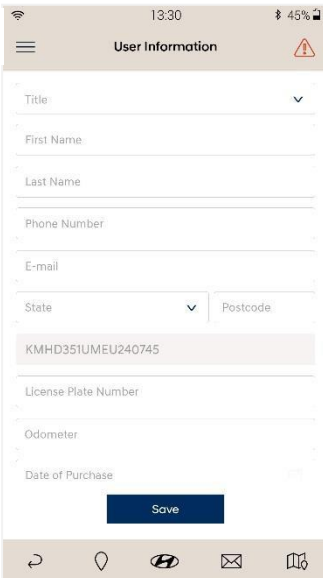

13:30 45%

User Information

Title

First Name

Last Name

Phone Number

E-mail

State Postcode

KMHD351UMEU240745

License Plate Number

Odometer

Date of Purchase

Save

**2**

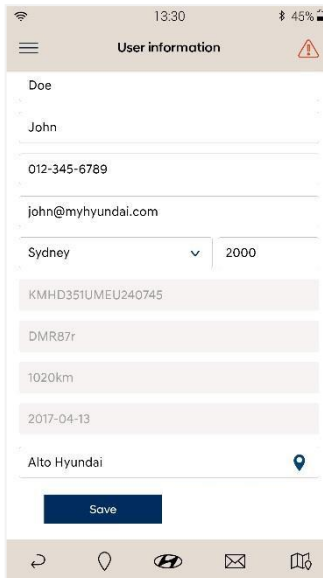

13:30 45%

User information

Doe

John

012-345-6789

john@myhyundai.com

Sydney 2000

KMHD351UMEU240745

DMR87r

1020km

2017-04-13

Alto Hyundai

Save

## User Guide.

### Application settings

Provides settings to enable/disable functions within the Hyundai Auto Link application, these include showing driving history, saving driving history and showing notifications.

### Driving history

1. Display driving history – enable/disable the driving history screens.
2. Data save in local – enable/disable your driving history being saved.
3. Allow notifications - enable/disable any Hyundai Auto Link notifications.

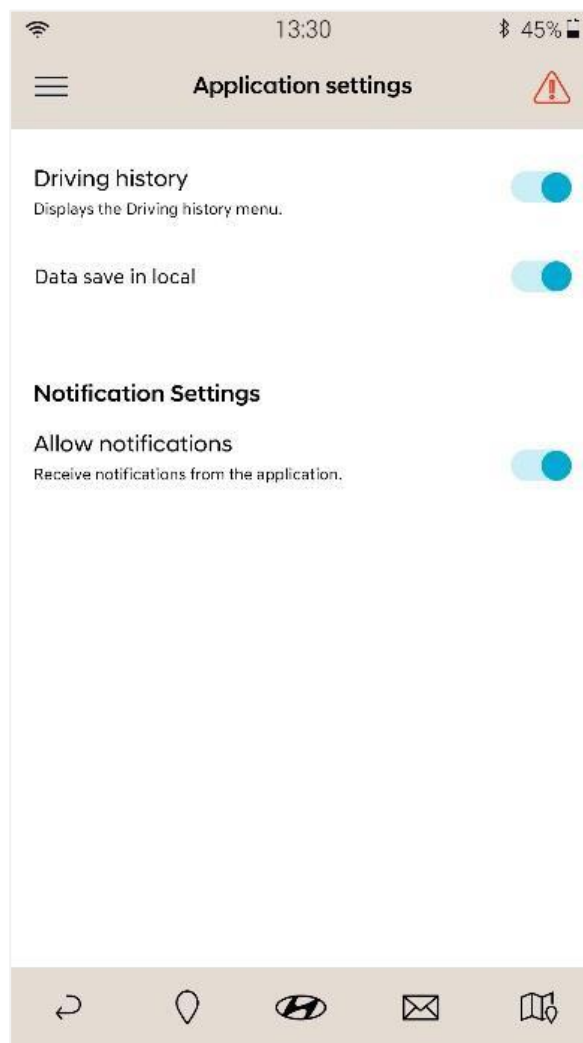

## User Guide.

### Program version

Provides the program version information

- Resource version
- Module firmware version
- Module database version
- Last successful data connection

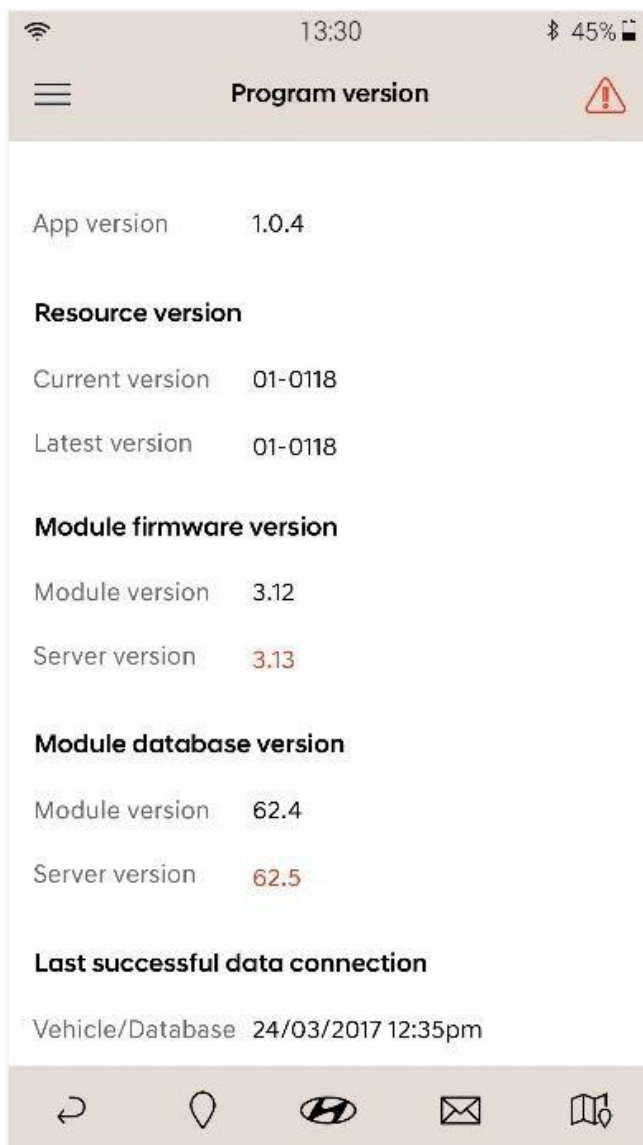

## User Guide.

### Unit settings

Set the units for fuel efficiency rating and Tyre pressure in the application.

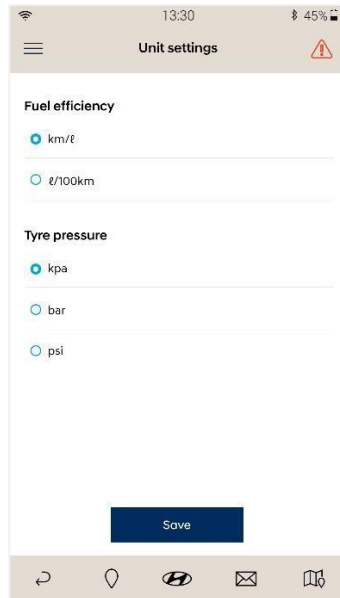

### Module diagnosis

#### A. Perform a self-test for modules diagnosis.

1. Press the "Start" button in the Bluetooth section to check the Bluetooth function with the DIAGNOSIS MODULE
2. Press the "Start" button in the Communication section to check communication between vehicle and DIAGNOSIS MODULE.
3. Press the "Start" button in the Software update section if you want to perform to software update on the diagnosis module.
4. The result of module check will display in green if the module is operating properly

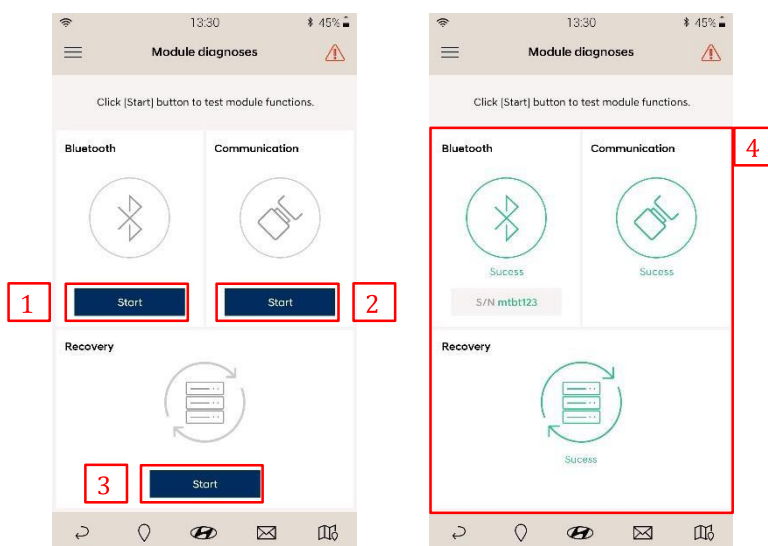



## User Guide.

### B. The result of Module diagnosis will display in red color if it fails

1. Press the “Solution” button on the failed section to show available solution instructions.
2. Apply the appropriate solution.
3. Press the ‘Back’ button to exit module diagnosis. Select the module diagnosis from the main menu and retry the Module diagnosis.

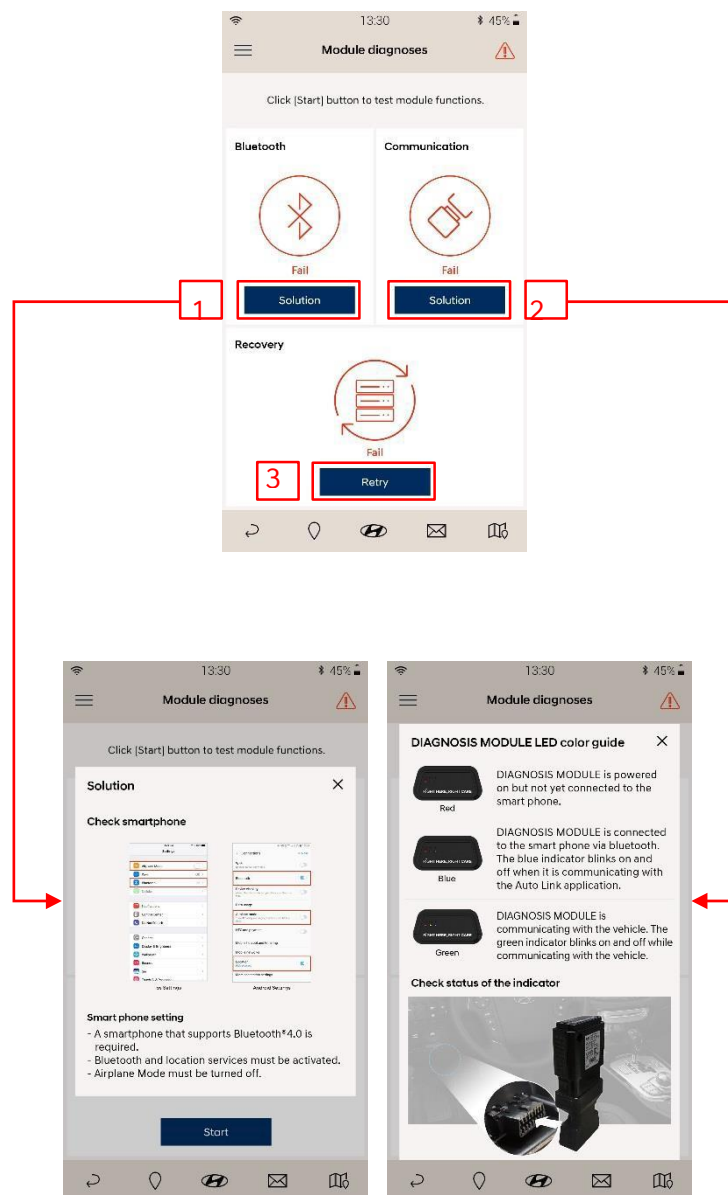

## User Guide.

### 6. Appendix

The Hyundai Auto Link Module is covered by your vehicle's 5 year limited warranty in accordance with the terms, and as published in, the owner's manual for the vehicle. Your vehicle's limited warranty does not cover the Hyundai Auto Link application which is provided to you on an "as-is" and "where-is" basis. In addition, Hyundai cannot promise uninterrupted or problem-free service, and cannot promise that the data or information provided to you will be complete, current or error-free. All data and information is provided to you through the Hyundai Auto Link application on an "as-is" basis. To the maximum extent permitted by law, Hyundai expressly disclaims any and all warranties of any kind, express or implied, about the Hyundai Auto Link application and any data and information and services provided through it, including, without limitation, any warranties as to content, quality, accuracy, timeliness, completeness, correctness, reliability, non-infringement, merchantability, or fitness for a particular purpose, and all such warranties are expressly excluded. Where a warranty cannot be excluded by law, if Hyundai breaches such a warranty in connection with the Hyundai Auto Link application, Hyundai reserves the right (to the extent permitted by law) to remedy the breach by providing the Hyundai Auto Link application again or paying for it to be provided again.

#### Copyright

Copyright©2016. All rights reserved by Hyundai Motor Company (HMC).

The copyright is held by HMC. Copying, publishing, licensing of texts, graphics or images of this guide without prior approval in writing are strictly prohibited.

HMC and Hyundai Motor Company Australia Pty Ltd (HMCA) each reserve the right to alter features of the Hyundai Auto Link application without notice. To the extent permitted by law, neither HMC nor HMCA shall be liable to any person as a result of reliance on the content of this user guide. Please consult your participating Hyundai dealer or Hyundai Customer Care for the latest information, features and benefits of the Hyundai Auto Link application.

#### DIAGNOSIS MODULE specifications

Item	Specifications
CPU	ARM 32-bit Cortex™-M3 (STM32F105RCT6) @ 7) @ 72MHz
Memory	Flash Memory 256KByte, SRAM 64KByte
Flash memory	8MByte
Operating voltage	DC 9V ~ 18V
Operating temperature	-10°C ~50°C
Storage temperature	-20°C ~80°C
Current consumption	Typical mode 120mA @ 12V Sleep mode 3mA @12V
Bluetooth protocol	Bluetooth Low Energy 4.1 (Power Class 2)
Can interface	High Speed CAN
Case	ABS

## User Guide.

### Notes regarding compliance

The Module complies with part 15 of the FCC Rules, US. Operation is subject to the following two conditions: (1) The Module may not cause harmful interference, and (2) the Module must accept any interference received, including interference that may cause undesired operation.

This product is CE marked according to the provision of the R&TTE Directive (99/5/EC). G.I.T., Co., Ltd., (as manufacturer of the Module) declares that this product is in compliance with the essential requirements and other relevant provisions of Directive 1999/5/EC



## User Guide.

### 7. Trouble shooting

#### **The DIAGNOSIS MODULE is not detected**

The main cause of this problem is that either the DIAGNOSIS MODULE is not connected to the OBD port or Bluetooth is turned OFF. Please check your module in accordance to the following instructions

1. Smart phone settings.
  - Make sure Airplane Mode is turned OFF.
  - Make sure Bluetooth is turned ON.
2. Check connection between the DIAGNOSIS MODULE and the OBD port. Also, check if the ignition is on and the engine is running.
  - Open the fuse box and check the LED status of the DIAGNOSIS MODULE.
  - Try reconnecting the DIAGNOSIS MODULE to the OBD port.
3. If the problem cannot be resolved by the above methods, please contact your Hyundai dealer or the Customer Care Centre for more information.

#### **Hyundai Auto Link application is not running**

The problem may occur due to application crash or malfunction of the smart phone's operating system. Please check your application in accordance to the following instructions.

1. Restart your smart phone and try again.
2. Uninstall the Hyundai Auto Link application from your smart phone and reinstall it through the App Store or Google Play Store.
3. If the problem cannot be resolved by the above methods, please contact your Hyundai dealer or the Customer Care centre for more information.

#### **Driving Information is not updated**

The problem may be caused by the Bluetooth connection and/or program version. Please check your application in accordance to the following instructions.

1. Check the Bluetooth connection between the DIAGNOSIS MODULE and the Hyundai Auto Link application.
2. Make sure your Hyundai Auto Link application is the latest update. You can check the current version on program version of configuration.